

INDEX LEGEND

COUNTY: Marion
SECTION: 17, T-75N, R-20W
CORNER: SW Cor. of the SE 1/4 of the SE 1/4

SURVEYOR & SURVEY COMPANY:
Jason S. Lowry, P.L.S.
Lowry Land Services, L.L.C.
752 Diamond Trail Rd., Searsboro, Iowa 50242

PREPARED BY AND RETURN TO:
Jason S. Lowry, P.L.S.
752 Diamond Trail Rd., Searsboro, Iowa 50242
(641) 521-1160, lowrylandservices@gmail.com

Instr. Number: 24-571
BK: 2024 PG: 571
Recorded: 2/16/2024 at 9:48:33.0 AM
County Recording Fee: \$7.00
Iowa E-Filing Fee: \$3.00
Combined Fee: \$10.00
Revenue Tax:
NAOMI ELLIS, RECORDER
Marion County, Iowa

UNITED STATES PUBLIC LAND SURVEY CORNER CERTIFICATE
Land Survey Monuments situated in Section 17, Township 75 North, Range 20 West of the Fifth Principal Meridian, Marion County, Iowa. Not previously recorded.

MONUMENT DESCRIPTION & REMARKS

SW Cor. SE 1/4 SE 1/4 - No record of corner being set. Searched area and found ancient corner post with fences north and south (fence west was offset due to ditch). Position fit calculated position within reason. Accepted corner post as best evidence and set 5/8" x 18" pink plastic capped rebar, P.L.S. #22291, on east side. No certificate of record.

This corner was used for a plat of survey in Sections 16 and 17.



PLAN VIEW

No Scale

SW Corner
of the SE 1/4
of the SE 1/4
Section 17

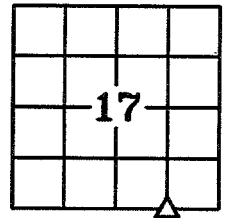

Set 5/8" x 18" pink plastic capped rebar, P.L.S. #22291

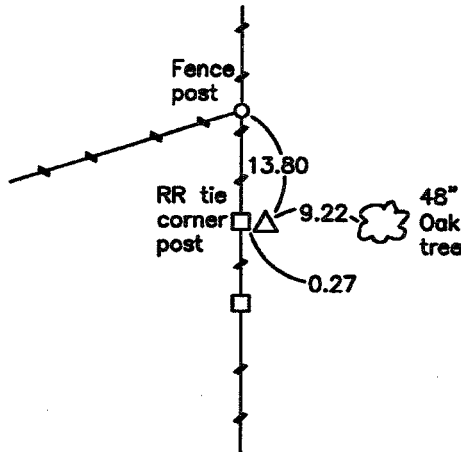

NOTE: ALL TIES ARE PLUMB MEASUREMENTS TO ORANGE SURVEY MARKER UNLESS NOTED.

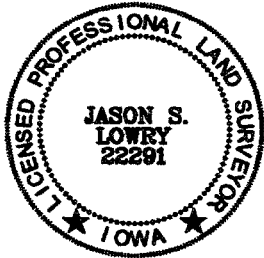

I hereby certify that this land surveying document was prepared and the related survey work was performed by me or under my direct personal supervision and that I am a duly Licensed Land Surveyor under the laws of the State of Iowa.

My license renewal date is 12/31/2025

Pages covered by this seal: 1 - 1

Jason S. Lowry
Jason S. Lowry

Iowa Lic. No. 22291

02/08/2024

Date

LEGEND

- ▲ Section Corner Found
- △ Section Corner Set
- Existing Fence

LAND CORNERS TO BE INDEXED

Land Corner	Section	Township	Range
SW Corner SE 1/4 SE 1/4	17	75	20

LOWRY LAND SERVICES, L.L.C.

752 DIAMOND TRAIL RD., SEARSBORO, IOWA 50242, 641-521-1160

PROJ. NO. 11923-2

DATE OF SURVEY: 01/31/24

CERT NO. 8/14