



Document 18-429

Book 2018 Page 429 Type CORNR Pages 1
Date 1/30/2018 Time 10:25 AM
Rec Amt \$7.00

KAREN SCHWANEBECK, RECORDER
MARION COUNTY IOWA

Prepared By: J. Brian Morrissey, Morrissey Surveying & Consulting, LLC, 1405 Hwy. G28, Otley, Ia. 50214, 515-480-2531

UNITED STATES PUBLIC LAND SURVEY CORNER CERTIFICATE OF

Land Survey Monuments situated in Section 19, Township 75N, Range 21W, of the Fifth Principal Meridian, Marion County, Iowa.
Previously recorded in N/A in the County Recorder's Office.
(book, page, document number, etc.)

(Show reason for preparing this certificate, the evidence and detailed procedures used in establishing the corner positions and monumentation found or placed.)

Monument Description and Remarks: Set 5/8" x 18" rebar with orange plastic cap #7995 at old 3-way fence corner.

This Corner was used for a Retracement Plat of Survey in the E 1/4 of the NW 1/4 of Sec. 19, recorded in Bk. 2017, P. 945.

PLAN VIEW

(Show a minimum of three reference ties to durable physical objects, relevant monuments and physical conditions that will enable recovery of the corner.)

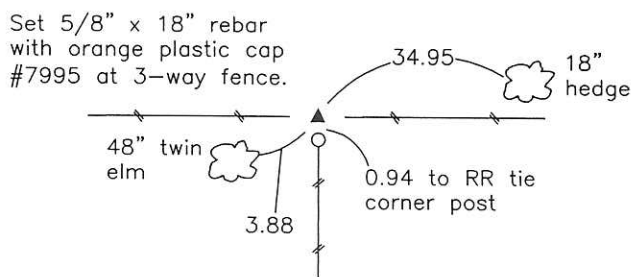
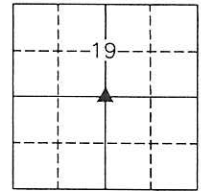

Center, Section 19

Date of Survey: 2/1/17

NOTE: ALL TIES TO BRASS DISK OR YELLOW/ORANGE SURVEY MARKER UNLESS NOTED.

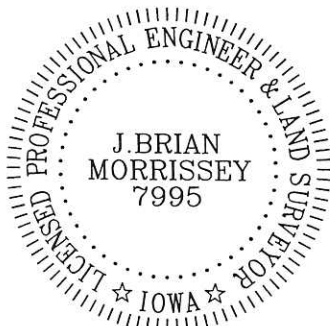

I hereby certify that this land surveying document was prepared and the related survey work was performed by me or under my direct personal supervision and that I am a duly Licensed Land Surveyor under the laws of the state of Iowa.

Signature: J. Brian Morrissey Date: 1/29/18
J. Brian Morrissey

License number 7995.

My license renewal date is December 31, 2019

888-16-2/5

Ret. \$700 ok - Ret Morrissey Surveying