

4/19/06 - Fnd. Granite Stone 10" x 10" x 10" exposed  
0.48' SE of Mag Nail in Cor. post

Remains of very old Hedge Post (Cor.)  
Between Posts stone lines up w/  
FC. N-S-W. Chiselled hole in  
Center Top of Stone

NE Cor NW-SW Sec. 25-77-19

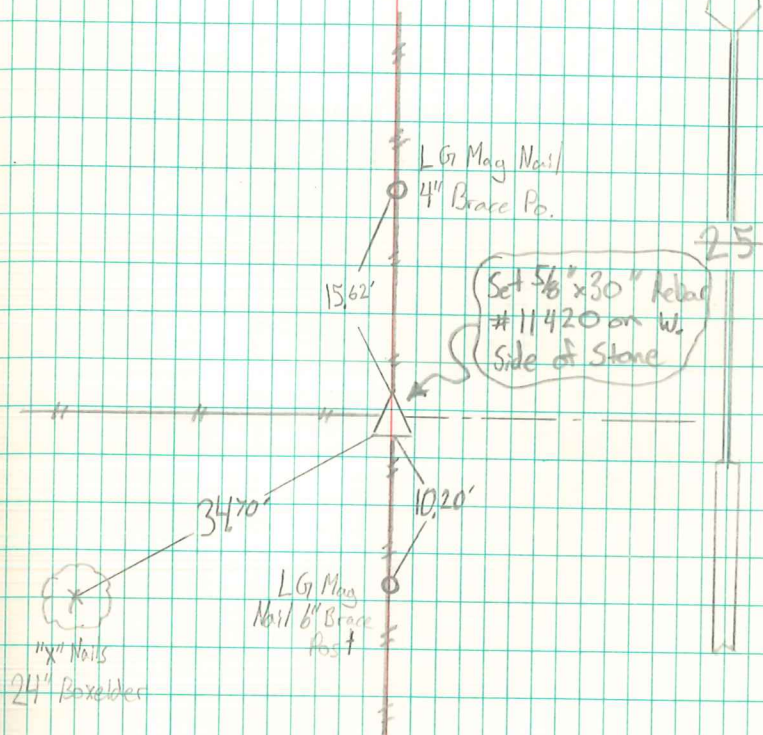

5/2/06  
Gary Wayne Keith