

Found 2-3" Drain Tile top one
was filled with conc. & rock

Set c.m. over both tile

c.m. 7" under surface

E¹/₄ Cor 28-77-19

Set-3-25-41

Notes - Kennedy

Party - Shore Ogden

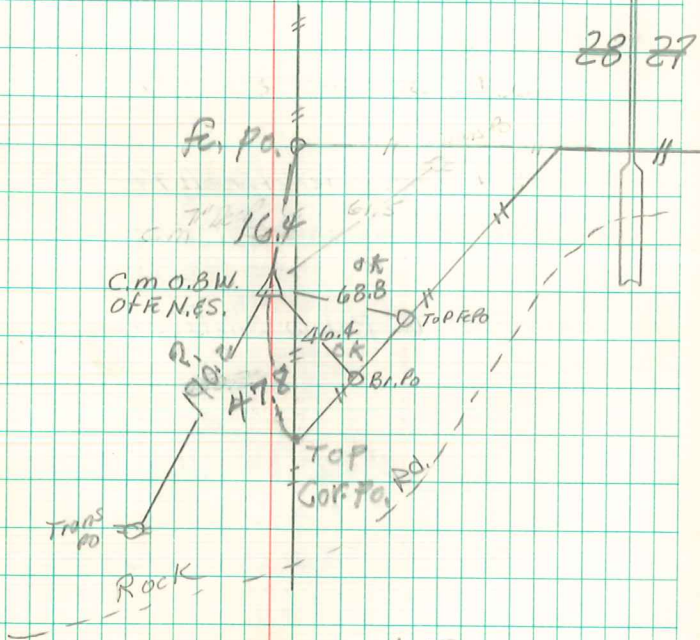
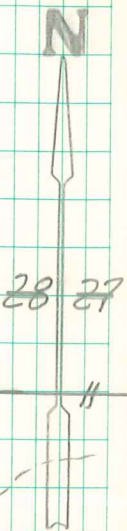

Found & Retied

11-30-84

R.C. Vinson

Found Conc. Mon. 15" deep

0.8' west of N.S. fc, Set

1/2" iron pin on E. side

Abie Davis 2/27/01