

Found 2 Stone, wagon Hub &  
1-2½" A tile

set c.m. on top of 2½" tile in place  
set stone on south side c.m. &  
wagon Hub on east side of c.m.  
also set stone on top of c.m.

E ¼ Cor 2-77-19

Set-10-22-40

Notes- Wignall

Party- Shore-mitchell

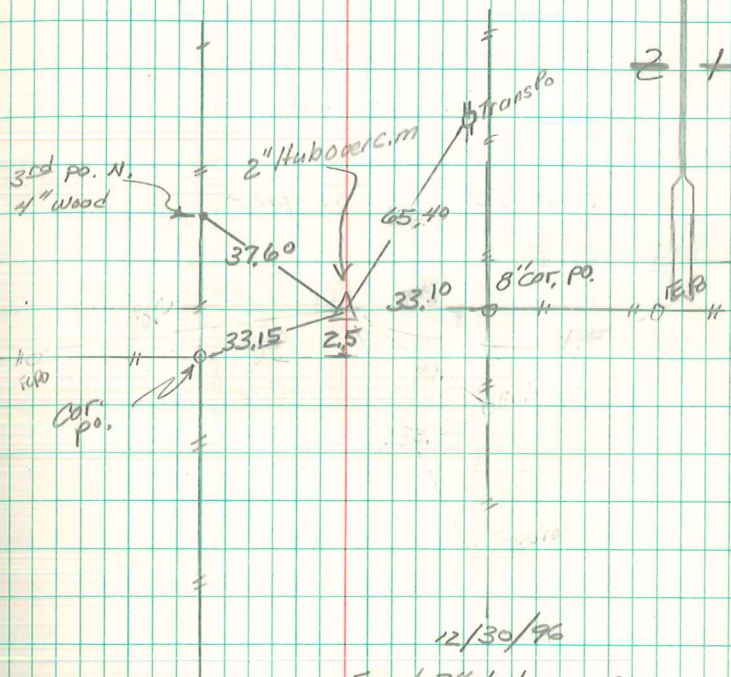

12/30/96

Found 2" hub over c.m.  
set 5/8" iron pin 4" deep  
over c.m. Abie Davis